

QUALITY MODE (NUMBER OF RECORDED PIXELS)

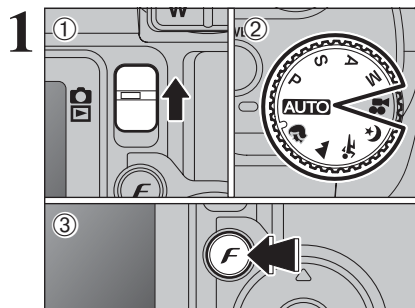

- ① Set the Mode switch to "P".
- ② Set the Mode dial to Photography mode.
- ③ Press the "F" button.

The quality setting is retained even when the camera is off or the mode is changed.

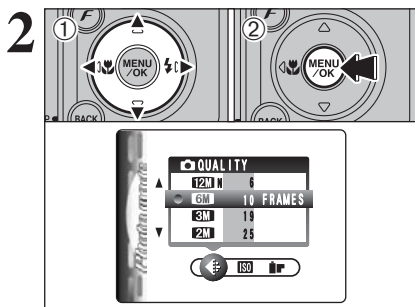

- ① Press "◀" or "▶" to select the "QUALITY" setting and then press "▲" or "▼" to change the setting.
- ② Press the "MENU/OK" button to confirm the setting.

- The numbers to the right of each setting show the number of available frames.
- When changing the quality setting, the number of available frames also changes (⇒P.24).

Quality settings in Photography mode

Quality mode	Sample Uses
12M F (4048 × 3040)	Printing at up to 14 × 17 in. (35.6 × 43.2 cm) / A3 size For better quality, select "12M F"
12M N (4048 × 3040)	Printing at up to 14 × 17 in. (35.6 × 43.2 cm) / A3 size
6M (2848 × 2136)	Printing at up to 10R (25.4 × 30.5 cm) / A4 size
3M (2048 × 1536)	Printing at up to 6R (15.2 × 20.3 cm) / A5 size
2M (1600 × 1200)	Printing at up to 4R (10.2 × 15.2 cm) / A6 size
03M (640 × 480)	To use for e-mail or web site

Quality setting in high-sensitivity mode

When a high-sensitivity setting (ISO 800) is selected, the "6M" and "12M" quality modes are no longer available. The "03M", "2M" and "3M" quality modes can be selected.

ISO SENSITIVITY

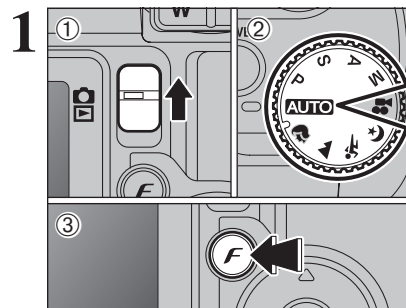

- ① Set the Mode switch to "P".
- ② Set the Mode dial to Photography mode.
- ③ Press the "F" button.

In "Movie" mode, do not set the "ISO" (sensitivity) setting.

Sensitivity is retained even when the camera is off or the mode is changed.

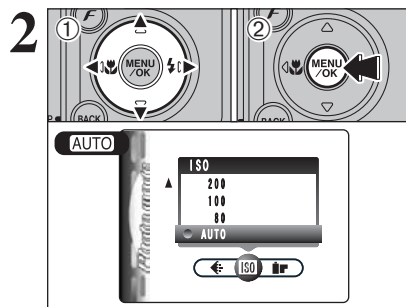

- ① Press "◀" or "▶" to select the "ISO" setting and then press "▲" or "▼" to change the setting.
- ② Press the "MENU/OK" button to confirm the setting.

Settings

AUTO: AUTO / 80/100/200/400/800

ISO, ▲, ▼, P, S, A and M: 80/100/200/400/800

- When setting CCD-RAW (⇒P.85), only "80", "100", "200" and "400" sensitivity settings can be selected.
- While selecting a higher sensitivity setting will allow you to take pictures in darker locations, it will also increase the amount of speckling in your images. Streaking may also be visible in shots of scenes such as the night sky. Choose the sensitivity setting that best suits the conditions.

Selecting AUTO as the sensitivity setting, the camera selects the best sensitivity setting for the subject's brightness. Refer to "Specifications" (⇒P.117) for information on the AUTO sensitivity setting. The AUTO sensitivity setting can be selected in the "AUTO" Photography modes.

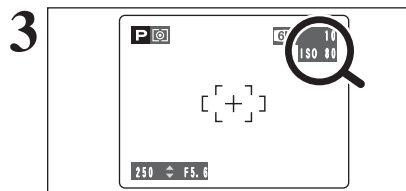

When the sensitivity is set to "80", "100", "200", "400" or "800" the selected sensitivity setting appears on the LCD monitor.